

Installation, operating and maintenance manual

Vision MKII

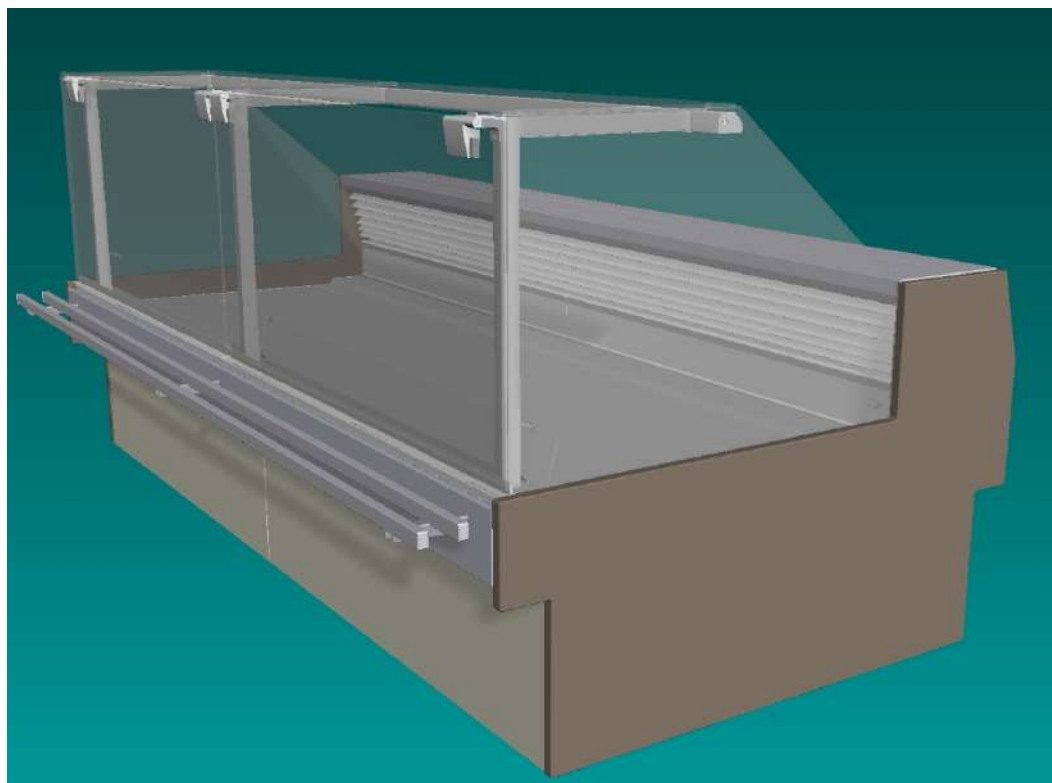

Smeva BV

Visiting address: J.F. Kennedylaan 27
5555 XC Valkenswaard

Telephone: +31 40 20 73 200
Internet: www.smeva.com

Specifications for the manual:

Date: December 2015
Version: 1.0

Scope of delivery & copyright	Vision MKII	
-------------------------------	-------------	--

Scope of delivery & copyright

The installation, operating and maintenance manual is part of this product. It must always be kept near the product. Following the instructions in this manual is a requirement for correct use of the product. The user manual corresponds to the product as constructed and meets all applicable safety-related standards.



The product consists of the following components:



Vision refrigerated display case for fresh products



Vision refrigerated display case for packaged products



Built-in control panel



Optional OEM control panel.



Optional ultrasonic humidifier



Optional reverse osmosis filter



Optional fish display case



Optional micro-misting



Accessories

Copyright

This manual is a publication of Smeva BV Valkenswaard, The Netherlands.

No part of this publication (including translations) may be reproduced in part or as a whole, stored in an electronic retrieval system, or transmitted in any form or by any means, including photocopying, microfilm, or otherwise, without the prior written permission of the publisher.

The manuals reflect the most recent product developments at the time of printing.

We reserve the right to make changes at any time, both to the technical specifications and construction.

© Smeva BV, The Netherlands. Printed in the Netherlands.

Overview Vision MKII display case for fresh products, KU flat glass (top-hinged)

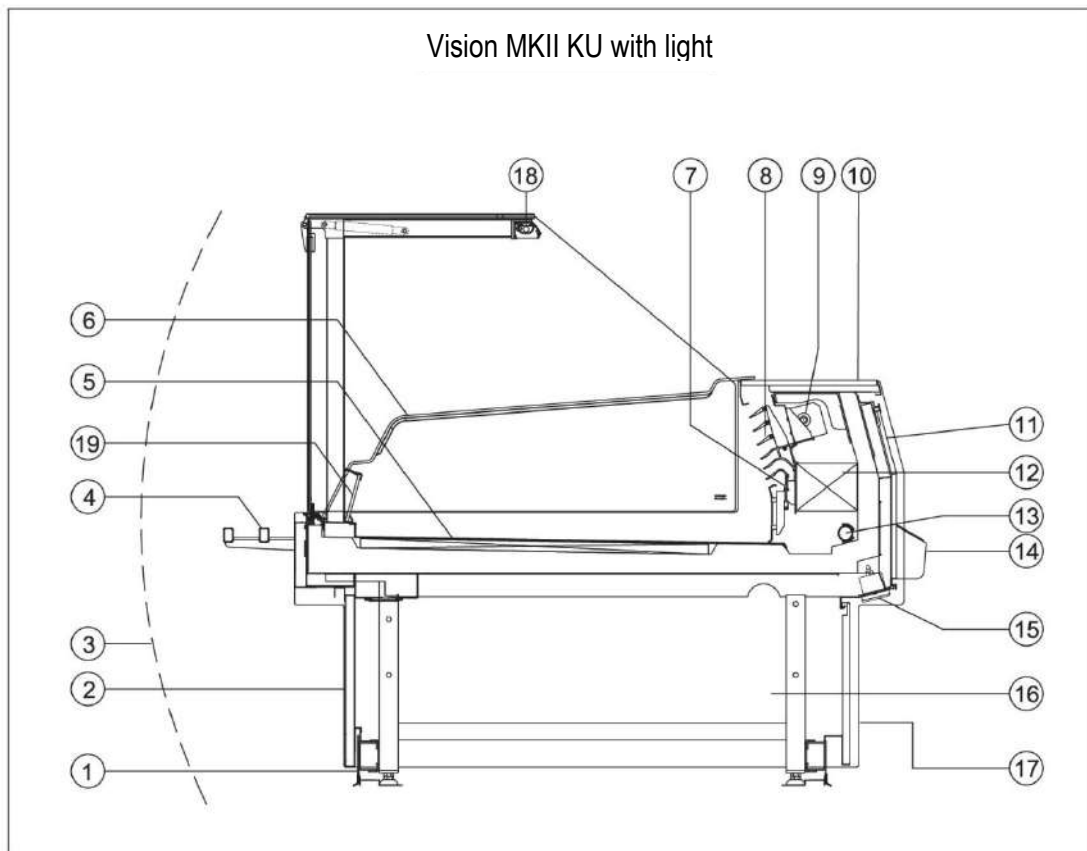

1. Skirting board
2. Front panel (S)
3. Front consumer side
4. Bumper rail
5. Cold plate (presentation surface)
6. Night cover
7. Discharge grille
8. Intake grille
9. Fan
10. Work surface
11. Product identification label
12. Cooled evaporator
13. Distribution pipe, ultrasonic mister
14. Thermostat control and switches, rear panel
15. Mains socket rail
16. Switch box, optional location of built-in machine / open storage
17. Service panel
18. Lighting profile, presentation surface
19. Air guide partition

Overview Vision MKII display case for fresh products, RO curved glass (top-hinged)

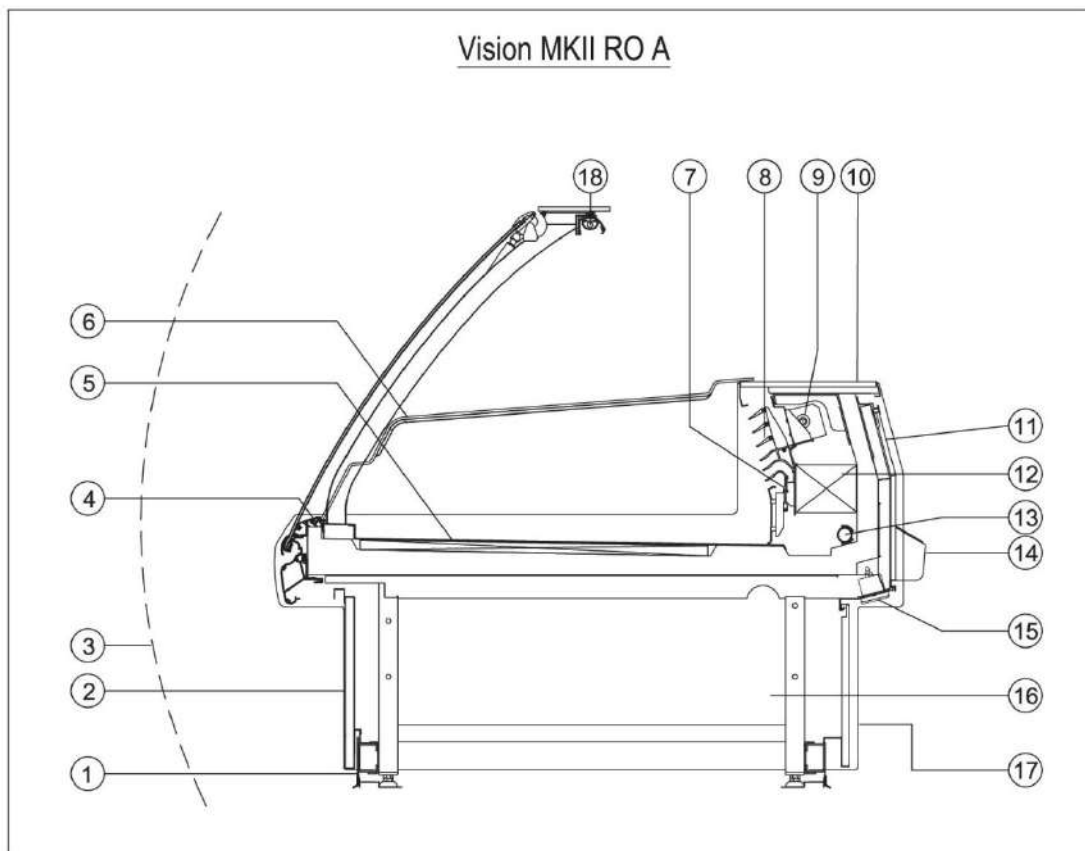

1. Skirting board
2. Front panel (S)
3. Front consumer side
4. Price card rail / label holder
5. Cold plate (presentation surface)
6. Night cover
7. Discharge grille
8. Intake grille
9. Fan
10. Work surface
11. Product identification label
12. Cooled evaporator
13. Distribution pipe, ultrasonic mister
14. Thermostat control and switches, rear panel
15. Mains socket rail
16. Switch box, optional location of built-in machine / open storage
17. Service panel
18. Lighting profile, presentation surface

Overview Vision MKII Panorama display case for fresh products, PA UV-bonded glass (bottom-hinged)

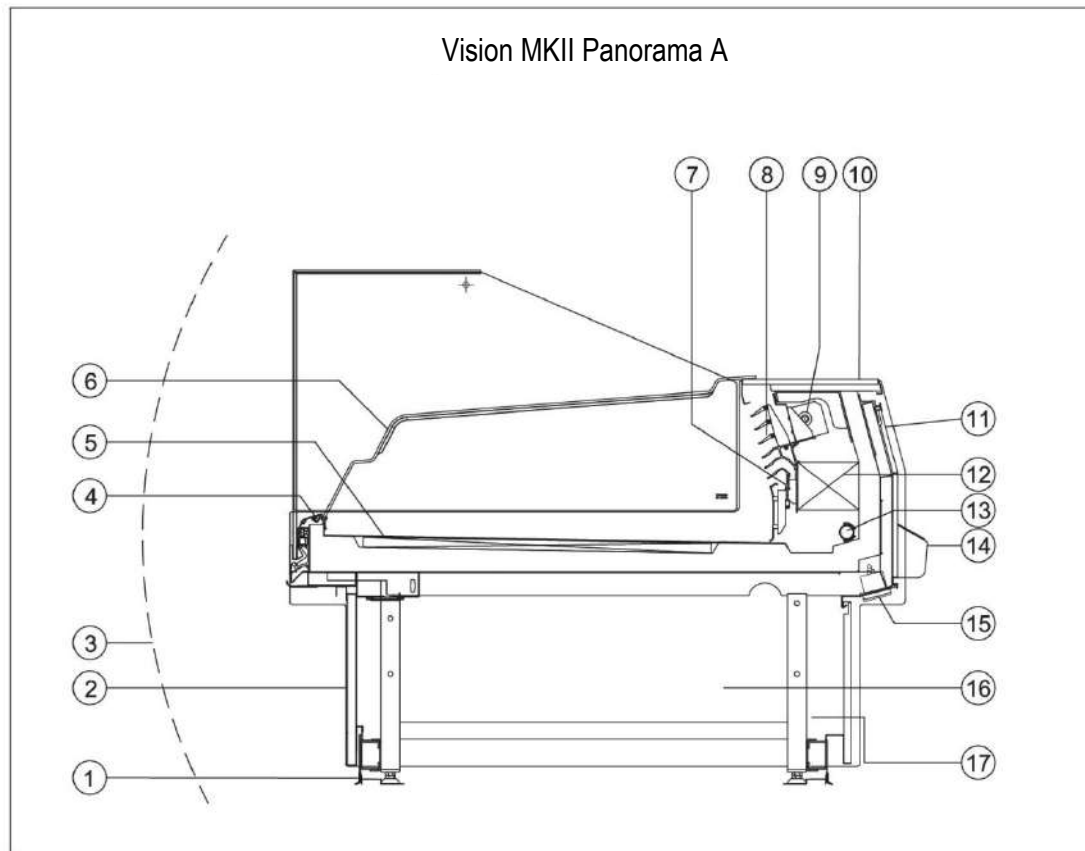

1. Skirting board
2. Front panel (S)
3. Front consumer side
4. Price card rail / label holder
5. Cold plate (presentation surface)
6. Night cover
7. Discharge grille
8. Intake grille
9. Fan
10. Work surface
11. Product identification label
12. Cooled evaporator
13. Distribution pipe, ultrasonic mister
14. Thermostat control and switches, rear panel
15. Mains socket rail
16. Switch box, optional location of built-in machine / open storage
17. Service panel

Overview Vision MKII display case for packaged products, KU-SP, flat self-service glass

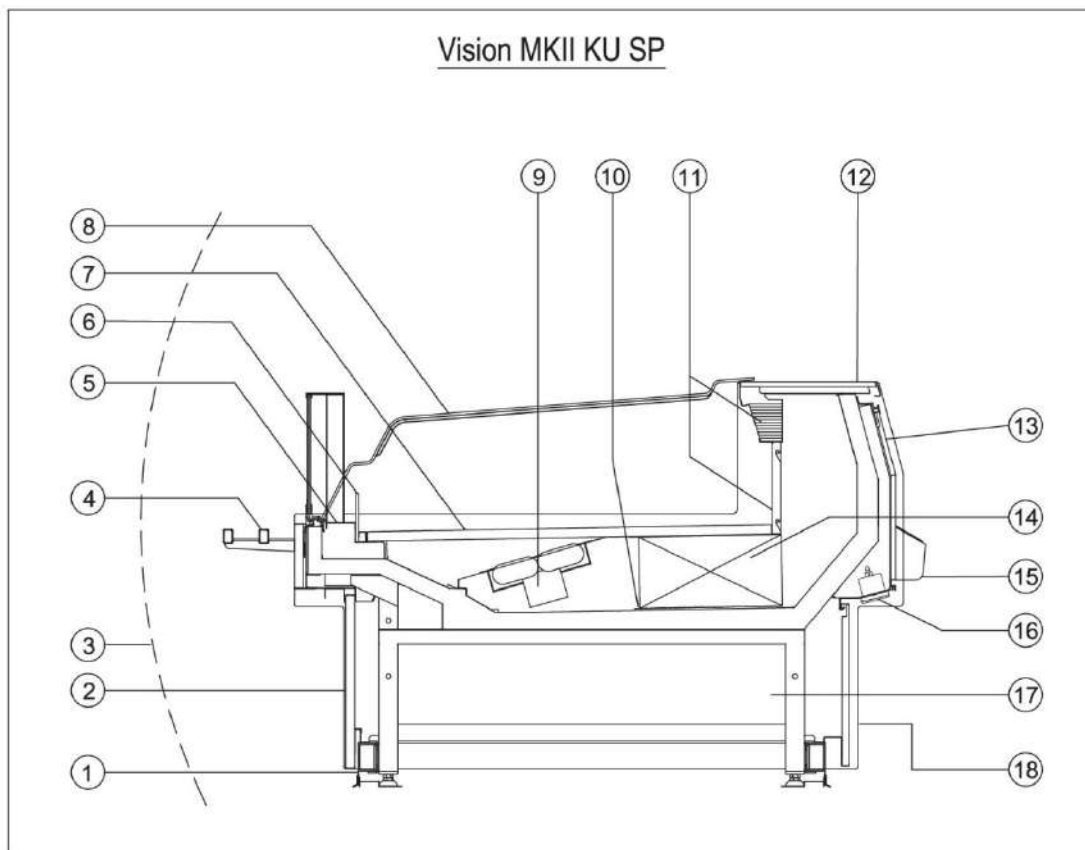

1. Skirting board
2. Front panel (S)
3. Front consumer side
4. Price card rail / label holder
5. Intake grille
6. Product stop
7. Cold shelf (presentation surface)
8. Night cover
9. Fan
10. Heater, electric defroster
11. Discharge grille
12. Work surface
13. Product identification label
14. Cooled evaporator
15. Thermostat control and switches, rear panel
16. Mains socket rail
17. Switch box, optional location of built-in machine / open storage
18. Service panel

Contents	Vision MKII	
----------	--------------------	--

Contents	
SCOPE OF DELIVERY & COPYRIGHT	1
CONTENTS.....	6
EXTERNAL DOCUMENTS	7
SAFETY	8
1 INTRODUCTION	11
2 TRANSPORT & INSTALLATION.....	12
3 GUIDELINES FOR USE.....	26
4 CLEANING & MAINTENANCE	37
5 END OF LIFE, DISASSEMBLY & DISPOSAL.....	46
6 TROUBLESHOOTING	47
7 PRODUCT IDENTIFICATION.....	48

External documents	Vision MKII	
--------------------	--------------------	--

External documents

External documentation

- Data sheet
- Electrical wiring diagram
- Refrigeration system diagram
- Floor plan
- Optional items



The external documentation is available on request from your Smeva partner.

Safety	Vision MKII	
--------	-------------	--

Safety

This user manual contains the basic guidelines that must be followed during use and operation of the product. The user must therefore read and fully understand the user manual before the product is put in use. Not only must the general safety instructions be followed, but the specific safety instructions below, indicated by a danger symbol, must also be respected.



The following stickers are found on the equipment:

- Warning stickers
- Product identification sticker & CE (see Chapter 7, Product identification)



This sticker indicates that you must consult the manual.



General warning symbol.



Danger due to electric voltage.



Danger due to moving parts.



Fire hazard.

Warnings

Failure to observe the safety instructions and comply with the safety guidelines can result in situations that are hazardous to people and may cause damage to the product. Failure to comply with the safety guidelines can lead to loss of the right to compensation for damages and may void the warranty. More specifically, failure to comply with the safety guidelines may result in dangers, such as: Failure of important product functions, danger to people in connection with electrical and/or mechanical operation, and/or property damage.



Do not remove the stickers from the display appliance.



Glass panels:

During opening and cleaning only grasp the top edge of the glass panels, not the sides; otherwise you put yourself at risk of pinching/crushing. Open the glass panel completely to prevent it from falling closed.

Open one glass panel at a time, and close it again before you open another one.

Due to the low visibility of the glass, do not leave the display appliance unattended with the glass panel in the open position; employees and customers might walk into it.

**Maximum load.**

Do not place weight on any surface of the display case that exceeds the maximum weight limit. Never exceed the maximum load. (See Chapter 3, Guidelines for use).

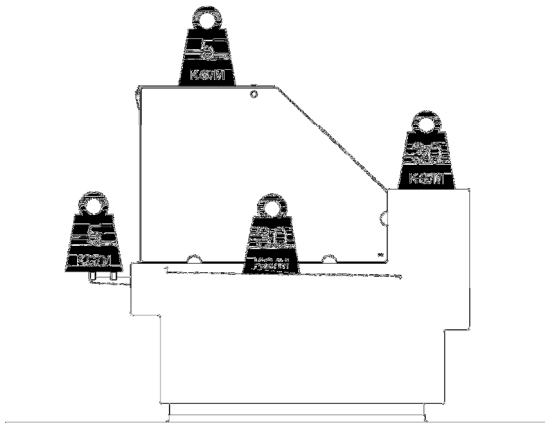
**Fall hazard.**

Never climb in or on the display case.

**Electrical hazard:**

All the electrical parts are located outside of the 'wet' working area.

Mains sockets, control panel and main switch are located on the serving side.

The electrical connection box and devices are located on the serving side, behind the service panel.

**Danger due to moving parts:**

Fan present near the evaporator. Danger of injury on contact. Hair and clothing becoming entangled in the fan.

**Fire hazard:**

The integrated condensers (if present) contain flammable refrigerant.

Follow the instructions on the label to prevent risk of fire in the event of a refrigerant leak in the display case.

Cleaning:

Before cleaning the presentation surface always switch off the refrigeration system at the control panel.

Safety	Vision MKII	
--------	--------------------	--



The presentation surface of display cases with a non-removable cold plate must be cleaned with soap and lots of water. Never spray water on the electrical parts beyond this surface.

- The control panels
- The mains sockets
- The fans
- The anti-condensation nose fans (hidden behind the nose profile)
- The lighting
- The technical areas located under the display appliance and behind the service panel.

1 Introduction

You made a good decision when you purchased the Vision display case for fresh product presentation from Smeva.

The Vision display cases are specially designed for the refrigerated presentation of fresh products. For the presentation of products with more stacking height there is also a display case with forced air cooling available, suitable for the presentation of packaged products. This optional display case is also delivered with a low glass panel for self-service.

Technical characteristics of the Vision series:

- The display case can be built with various temperature zones.
- The presentation surface is made of polished 304 stainless steel.
- The presentation surface is non-removable, refrigerated and slightly angled for easy cleaning and draining toward the serving side. An easily accessible trough with drain is located behind the discharge grilles for the cooled air.
- Optional ultrasonic humidifier for fresh products. The water supply for the humidifier is filtered with a reverse osmosis filter.
- Optional fish tray for presentation of fresh fish on crushed ice.
- Optional micro-misting for fresh fish. The water supply for the micro-misting is filtered with a reverse osmosis filter.



This manual describes the correct use of your Vision display case, which is guaranteed by Smeva for quality, reliability and use of the latest technological developments.



As owner and/or HACPP manager you are legally required to document the maintenance of the display case. For the purposes of product liability and warranty you are required to have your display case inspected annually by an authorized technician. See also Chapter 4, Cleaning and maintenance.



As an extra service, a brief troubleshooting guide is enclosed, which can be used to resolve simple, minor malfunctions. For more complicated malfunctions and/or defects of the display appliance you must contact your Smeva partner.

2 Transport & installation	Vision MKII	
----------------------------	-------------	--

2 Transport & installation



Shipping

The display case is packed in plastic film for transport. The edges and corners are also protected with hard foam or corrugated cardboard. To the extent possible, all parts and options have been preinstalled at the factory.



Depending on the type of glass panels, the glass is supported with wooden beams or the glass has been removed to prevent damage during transport. The glass at the ends has also been removed.



Inspect all parts immediately at the time of delivery. Document all irregularities in writing. Always contact the Smeva partner responsible for the product.



All material for installation and all accessories are located in the display case or are preinstalled. Contact your Smeva partner if anything is missing, before you complete the installation.



Photo of transport beam (consumer side).

Transport at location.

The display case is delivered in straight and corner sections up to 7.5 m in length with transport beams. The figure shows the position of one of the transport beams, as seen from the front side.



Lifting of the display case must be done with lifting equipment that is carefully inserted between the wooden transport beams and beneath the steel profiles, carefully balanced in the centre of the length and weight of the display case.



The total weight of the display case is shown on the Vision data sheet.



Insert the forklift fork completely, under the steel profiles at the front and back.



Make sure none of the display case parts or electrical cables are hanging loose and become pinched between the fork and the display case.

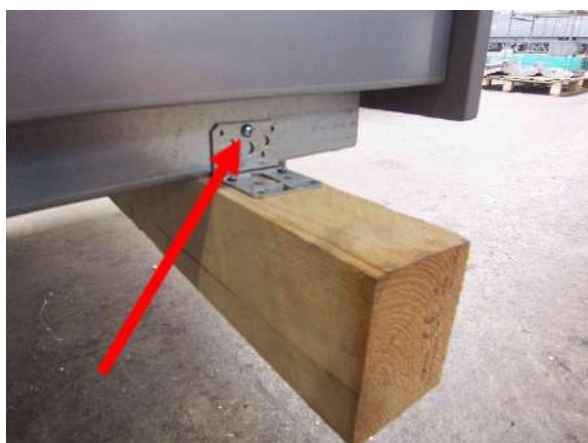

Photo of transport beam on serving side, with the single screw in the metal frame visible.

Placement



See the floorplan for the correct dimensions.



Make sure the cables and pipes coming out of the floor do not become pinched under the display case.



The wooden transport beam can be detached by removing a single screw from the serving side of the display case (see figure) and using a hammer carefully, if the beam is stuck.



Phillips screwdriver



Hammer

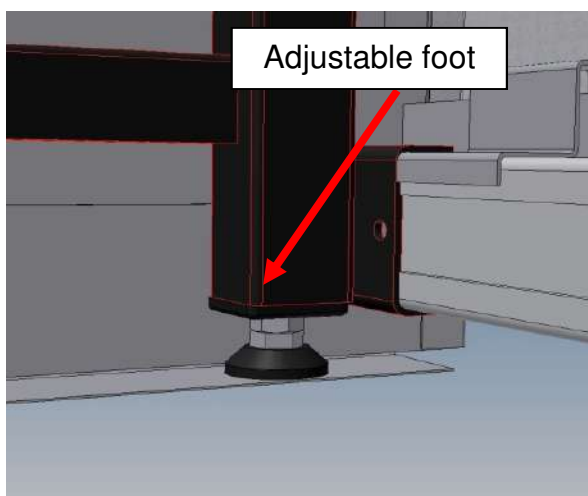

Levelling

Level the display case and adjust it to the correct height using the adjustable feet.



Place the skirting board stand-offs under the adjustable feet before you level the display case.



17 mm spanner



Spirit level



Spirit level



Removing the front panels

1. Lift up the panel.
2. Pull the panel toward you.
3. Pull the panel down until the top side detaches.

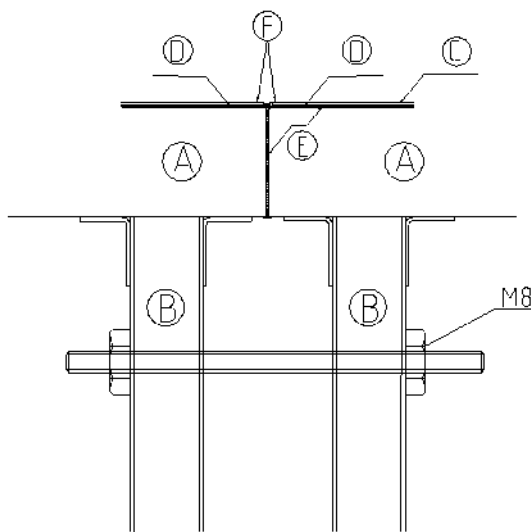
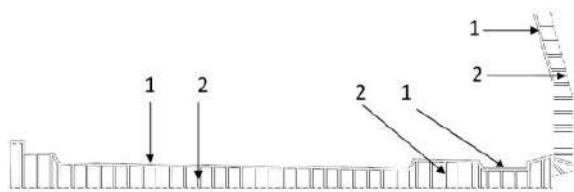

- A) Shell
- B) Frame
- C) Stainless steel presentation surface
- D) Connection plate
- E) Caulk
- F) Tape

Rinse water and hygienic sealing of display case joints

Apply caulk between the PU foam parts:

1. Apply a full bead of caulk to the top side (position: 1).
2. On the inside (position: 2) apply caulk in a vertical pattern to prevent entrapment of air bubbles.
3. Join the two display case sections together.
4. Remove the excess caulk.



Use soapy water to form a smooth, continuous caulk surface.



Apply the caulk before the display cases are joined together. The application of caulk after joining will result in leakage.



Any excess caulk must be removed before the protective film is removed from the stainless steel presentation surface.



Caulk: (included)

Vision Curved Glass

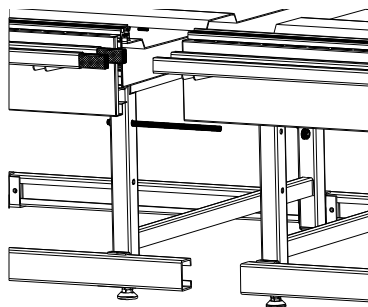
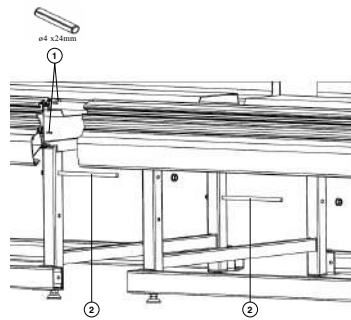

Vision Cube

Vision Panorama

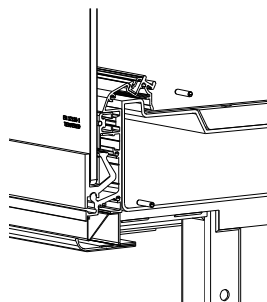

Assembly of joined display case sections

Joining is accomplished with threaded rods in the frame (1).

Align the aluminium nose profiles with round keys (2).



Aligned











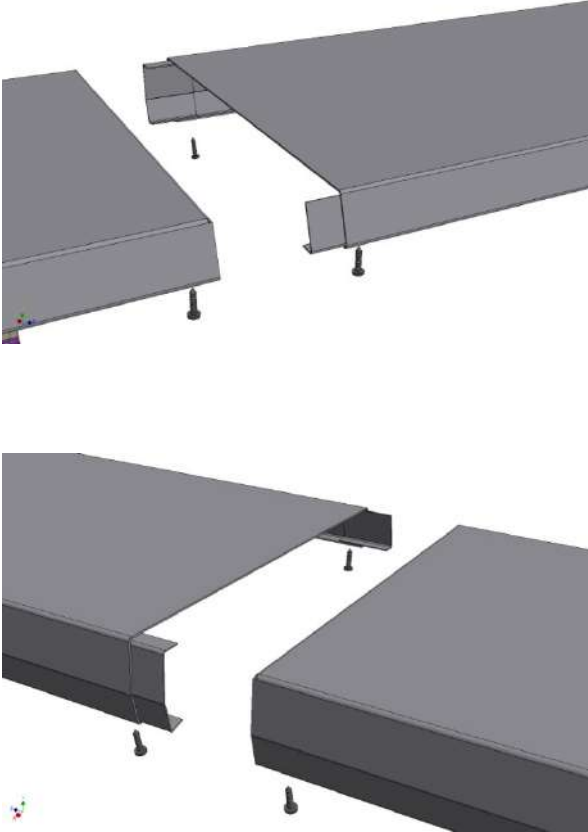

Threaded rods and M8 bolts (included)

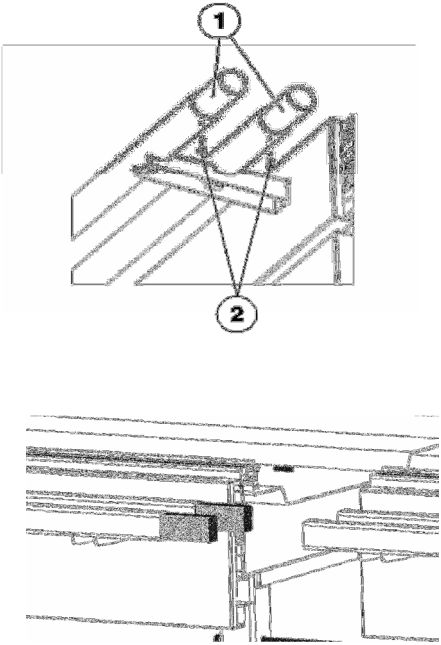

Round keys (included)

2 Transport & installation	Vision MKII	
----------------------------	-------------	--

	<p>Alignment of work surface with flat or square keys</p> <p>Align the stainless steel work surface with the two extending joining brackets (pos. 4) and screws (pos. 3).</p> <p> Aligned</p> <p> Joining bracket for stainless steel work surface (3, 4 included)</p>
	<p>Alignment of lighting profiles</p> <p>Align the aluminium lighting profiles with round keys and flat joining plate.</p> <ol style="list-style-type: none"> 1. round key 2. flat screw 3. plate 4. nuts <p> Aligned</p> <p> Allen wrench</p> <p> Open-end spanner</p>

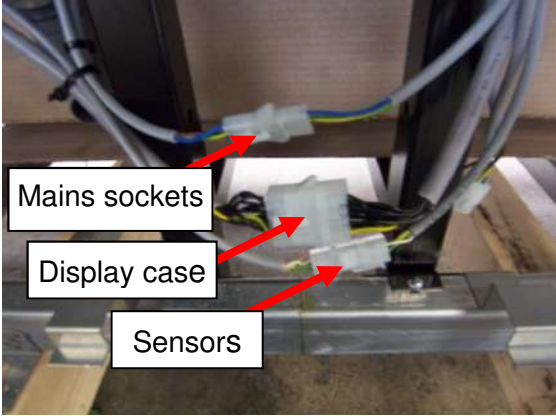
	<p>Alignment of bumper rail or bag bench holder</p> <p>Align the bumper rail or bag bench with the appropriate keys.</p> <div>  Aligned </div> <ul style="list-style-type: none">  Square or round bumper rail and bag bench holder: keys (included)  Stainless steel bag bench holder: bolts (included)
 <div> Mains sockets Display case Sensors </div>	<p>Connecting electrical wiring between display cases</p> <p>Electrical connection is made by connecting the prepared plugs and mating plugs under the various display cases.</p>



Connecting refrigeration system between display cases

Refrigeration pipes and valves are prepared under the display case.



Pipes, copper, sealed under moderate pressure (0.5 bar).



Diameter depends on display case length and cooling capacity (see machine sticker and cooling capacity).



Soldering and connection of a refrigeration system may only be done by a nationally certified, authorized professional.

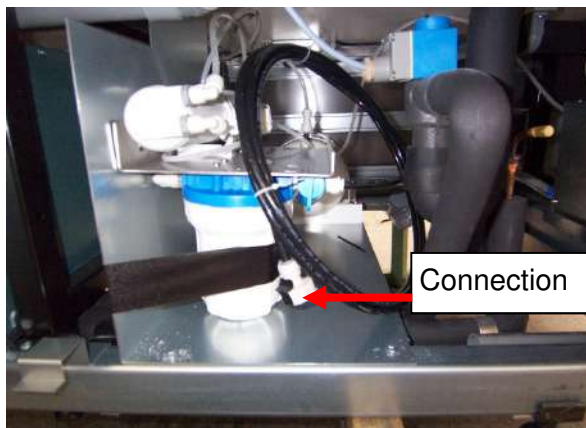

Connecting water supply between display cases

(if equipped with humidifier).

Water line connections are prepared under the display case (Ø6 mm).



Connect the line that comes from the water filter system in the first display case to the quick connect on the humidifier in the next display case section.



No leakage

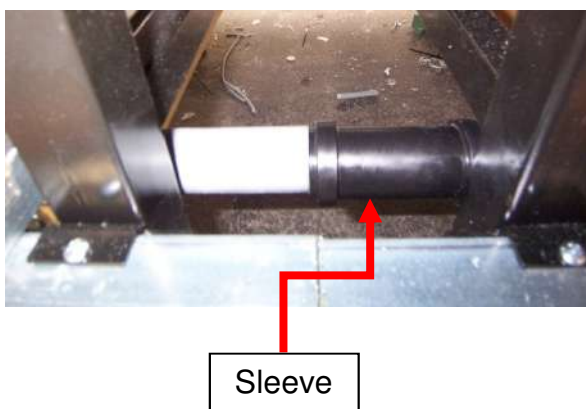

Connecting drain system between display cases

The drain system is prepared under the display case (PVC Ø40 mm).



Connect the drain between the two display cases with a plastic sleeve (Ø40 mm).



Sleeve 40 mm (included)



No leakage

2 Transport & installation	Vision MKII	
----------------------------	-------------	--



Connecting ultrasonic humidifier between display cases

The distribution pipe for the optional ultrasonic humidifier (located under the evaporator) is connected by means of a plastic sleeve (Ø32 mm).



Sleeve 32 mm (included)



Connecting micro-misting humidification system between display cases

The distribution line for the optional micro-mister is connected to the atomizer hose in the next section by means of Ø6 mm hose with quick connects.



6 mm connection line (included)



No leakage



Skirting board stand-off, shown without the skirting board.

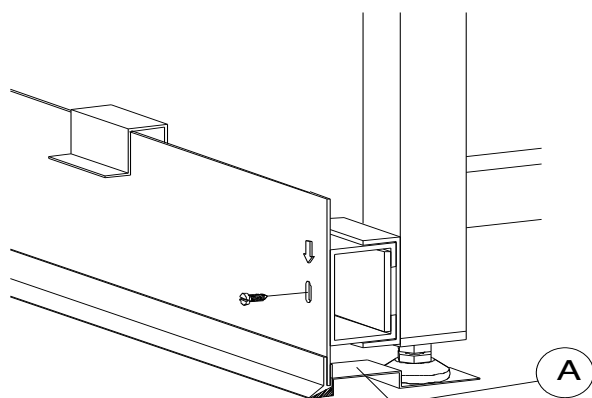

Fitting the skirting boards

A normal skirting board and a skirting board stand-off (A) are fitted on both the serving and consumer side (see figure). Use the plastic sealing profiles to prevent cleaning water from running under the display case.



#2 Phillips screwdriver



Self-tapping screws (included)



Black colour for black skirting boards



Use the higher skirting board on the front side. The front panels slide over the skirting boards so the adjustable feet are always covered and the display case is sealed at floor level.



Sealed at floor level



Fitting the front panels KU/PA

Fitting of the panels is done in the opposite order of removal (see 'Removing the front panels').

1. Push the panel up, behind the U-profile.
2. Push the bottom toward the display case.
3. Carefully lower the panel into the brackets.

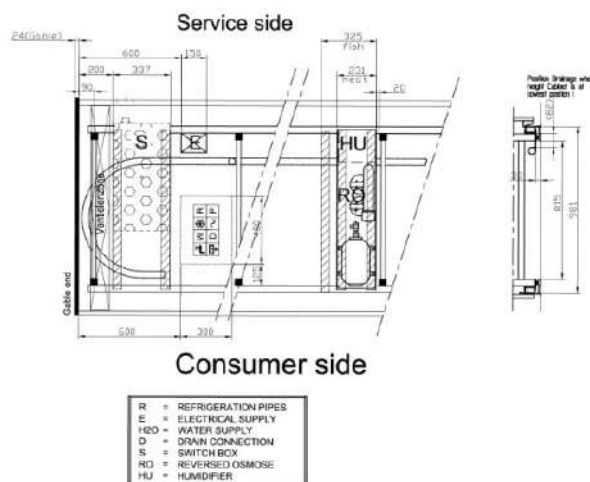

Panel vertical

**Final connections:**

Refrigeration system; Water and drain system;
Electrical supply.

All technical installation work must be performed by authorized professionals who are certified in accordance with national legislation. The refrigeration system is constructed in accordance with the international Pressure Equipment Directive (PED).

The electrical system is constructed in accordance with the international Low Voltage Directive.

Connecting the refrigeration pipe to the external refrigeration system:

Pipes, copper, are sealed and delivered under moderate pressure (0.5 bar).



When opening, observe whether the pipe is still under pressure. If not, contact your Smeva partner.



See the floor plan for the correct positions of the connections.



Diameter and cooling capacity depend on display case length (see machine sticker and product data sheet).



Make sure the external refrigeration system is charged with the correct refrigerant and matches the information on the type plate of the display case.

Connecting the water supply:

The display case is fitted with a 3/4" female adapter. Install a 3/4" male shut-off valve with non-return valve (if equipped with humidification).



Shut-off valve with 3/4" male adapter with non-return valve (**not included**).



Preparations for optional water system provided under substructure: Ø6 mm and Ø10 mm plastic lines with quick connects.

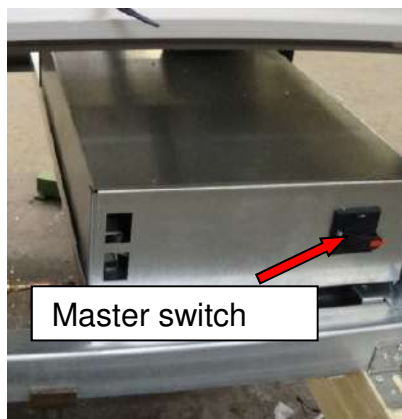
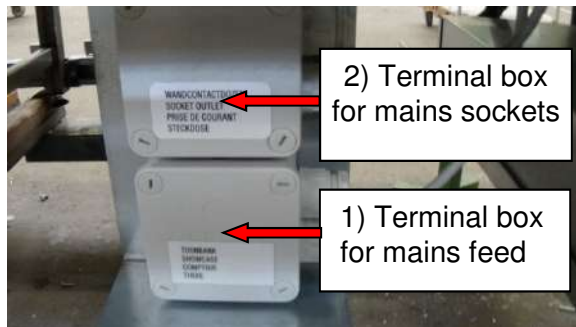

Connecting the drain:

Ø40 mm PVC pipe fitted with flexible Ø40 mm connection sleeve. Turn the trap 180° so it points down at floor level between the display case drain line and the sewer connection.



See the drawing of the floor plan for the location of the specific connections.



Drain trap at floor level between display case drain line and the sewer connection (included).

Final electrical connections

1. Power supply for display case

The electrical connection is made by connecting the mains feed to the electrical terminal box in the frame (cable gland size PG16).

2. Power supply for mains sockets

A separate terminal box in the frame.



All the wiring in the display appliance to the controller and the electrical components has been preinstalled by the manufacturer.



Any network connection wires are connected directly to the controllers. Devices (e.g. cash register/weigh scale) are connected directly to the network and are not included (supplied by third parties).



Switch the display case on and off with the master switch on the switch box.

3 Guidelines for use

General

To guarantee optimum performance from your Vision display case, please carefully adhere to the following guidelines:

- The display case must be carefully cleaned and the pre-set temperature must be reached before you fill it with your products.
- Products must be at the required temperature before they are placed in the display case. The display case is not designed to reduce the temperature of a large volume of products; it is only intended for presentation.
- Do not fill above the fill level, as indicated on the stickers on the glass side panels, because doing so prevents the cooled air from effectively reaching the products.
- Never climb in or on the display case (see the chapter on safety).
- Do not place weight on any surface of the display case that exceeds the maximum limit. Always observe the maximum weight limits (see the chapter on safety).
- Prevent sunlight or shop lighting from shining directly on the presentation surface of the display case.
- Do not place the display case close to heat sources.
- Prevent draughts around the display case, such as can be caused by air vents, open doors and shop windows or an open storefront.

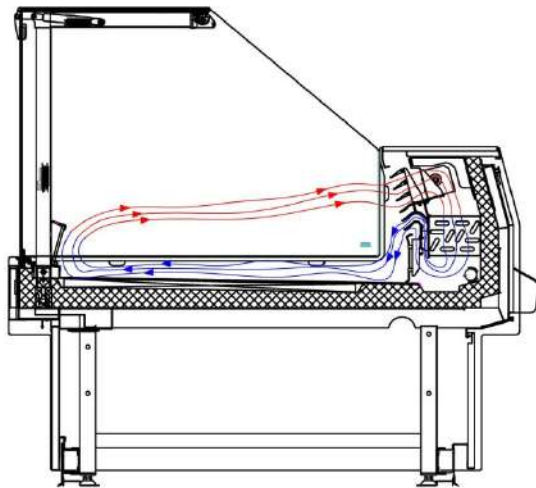

Air circulation presentation surface Vision for fresh products with a non-removable presentation surface.

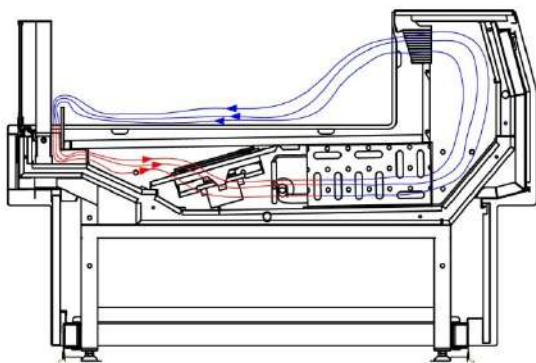

Air circulation presentation surface Vision for packaged products with a removable presentation surface.

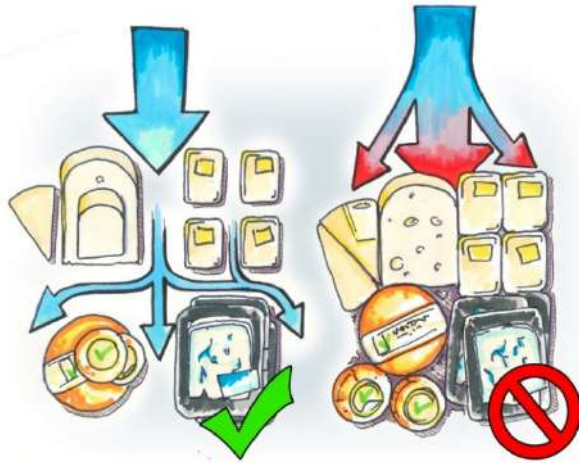

Lighting and draughts are a major cause of hot spots, drying out and discolouration of fresh and packaged products.

**Arranging fresh products****Vision with non-removable cold plate.**

The display case must be carefully cleaned and the required temperature must be reached before you fill it with products. The serve-over display case is only intended for fresh products.



Make sure the presentation surface is filled correctly, because this can affect the air circulation and the temperature.



Only fill the display case with precooled products.



Make sure the goods are not stacked too closely together. This will ensure sufficient air circulation around the goods.

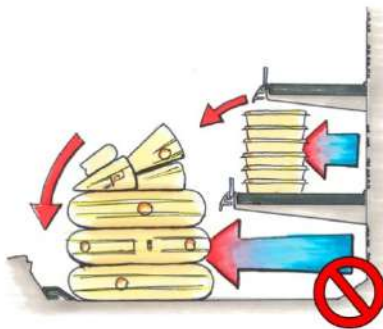
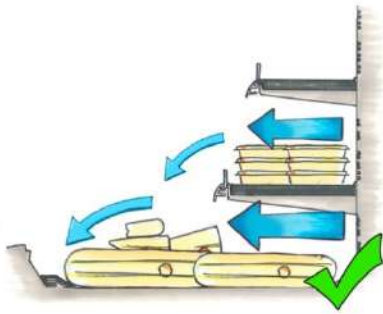

Arranging packaged products

Vision forced air with removable presentation surface.



Stacking goods too high can also have a negative impact on the air circulation.



Make sure the goods are not placed in front of the air discharge-at the rear nor on top of the intake grille at the front.



Do not obstruct the openings in the air grilles at the front and rear. Make sure the openings of the-intake grille do not become blocked by products, boards, trays, etc. This can obstruct the air circulation, which can in turn lead to unacceptably high product temperatures!

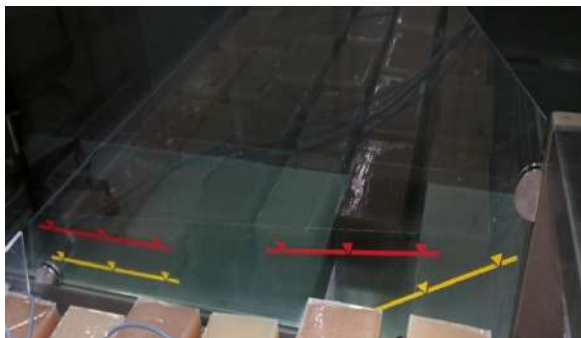

Fill level



Do not fill above the fill level, as indicated by the stickers on the glass side panels, because this will prevent the cooled air from effectively reaching the products.



Sticker:

Yellow (M0) Product core temp. Max. 4 °C



Sticker:

Red (M1) Product core temp. Max. 5 °C



Hanging shelves



Optional hanging shelves are available for creating a tiered presentation.



Always maintain a gap of approximately 2 cm between the hanging shelves (with slotted holes) and the discharge grille to ensure good circulation of the cold airflow.

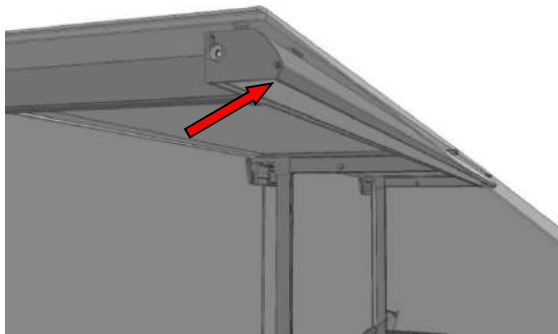

Lighting

LED lighting is mounted in the lighting profile.



Use only original LED lighting from SMEVA intended specifically for your products. Ask your dealer for the available colours.



The light switch is located in the control panel.



The light switch may have a dual function: Depending on the type of controller, a night program may start automatically as soon as the light is switched off. The night mode only works correctly when the night covers are placed in the display case.



Control panel/thermostat



Depending on the product, the recommended set-point for the thermostat lies between -4 and +2 °C, with a 2 K differential.

Vision cold plate for fresh products:

Recommended defrosting cycles:

6x max 60 min/24 hrs

Defrost stop +6 °C

Recommended setting:

- Start defrosting: 00:00, 04:00, 08:00, 12:00, 16:00, 20:00.

Vision forced-air for packaged products:

Recommended defrosting cycles: 4x 45 min/24 hrs

Defrost stop +6 °C (cycle off)

Defrost stop +8 °C (electric defrosting)

Night cover:

When night covers or roller curtains are used, the temperature set-point must be raised by 2 K to prevent your products from freezing. An additional benefit of doing so is that you reduce energy consumption by around 50% during the night, while still maintaining the correct product temperature. For more information about your temperature controller please refer to the manual for the specific OEM thermostatic controller.



Auxiliary equipment



Your Vision is equipped with guide panels for cables for connecting auxiliary equipment (e.g. weigh scales/cash registers).

5. Make a vertical cut from the edge of the membrane to the cable hole to feed the plug and lead of the auxiliary equipment through.
6. Pass the plug out through the hole in the mains socket rail in bottom. Connect the plug of the auxiliary equipment to the nearest mains socket.



Always accessible so the power can be disconnected in an emergency.



The cable duct can also be used to run data cables to your equipment.



There are mains sockets between the rear wall and the control panel on the serving side.

**Open bottom storage space**

Practical, dry storage space at room temperature for night covers and other storage purposes.

**Night cover**

Use of the night cover makes it possible to keep your products under ideal conditions during the night. The products remain under covered, dark conditions, and it is not necessary to remove them from the display case.



Energy consumption during the night is reduced by 50%. To prevent products from freezing, the raised night-time set-point of the controller must be active.



It is recommended that the display case be emptied at least once a week for thorough cleaning and defrosting of the accumulated ice in and under the evaporator.



Ultrasonic humidifier the Weightsaver (optional for fresh meat products)

The Weightsaver keeps the humidity level on the presentation surface high, which helps maintain the quality and appearance of the fresh products during presentation.

The switch for the Weightsaver is located in the control panel. The humidifier starts automatically when the water supply and reverse osmosis filter are activated.



The device is set to 100% capacity at the factory.



Depending on the length of the display case (up to max. 4.375 m) the setting can be reduced with the control knob which is located in the mains socket rail across from the unit.



For optimum distribution of the humidified air, the vapour tube is partially plugged at the factory, through the use of yellow plugs.



Extra plugs are included with the display case so you can plug certain sections for the presentation of products that are presented dry.



For more information about your Weightsaver please refer to the manual (included, on the inside of the service panel).





Micro-misting humidifier Miatche (optional for fresh fish and vegetables)

The micro-misting keeps the fresh fish moist and glossy, maintaining the quality and fresh appearance.

The micro-misting starts automatically when the display case is powered on.



The device is set at the factory to atomize for 2-3 seconds every 15-20 minutes.



The interval can be set with the adjustment knob on the front of the device, which is accessible behind the service panel.

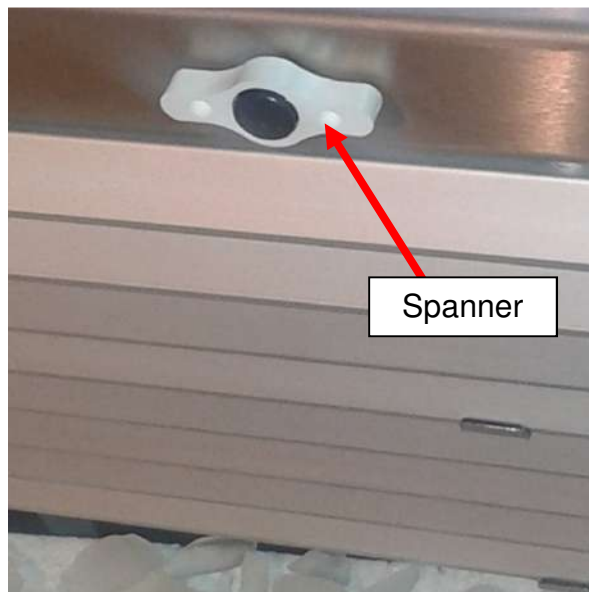

Spray adjustment for micro-misting

It is possible to partially close the nozzles by setting them with the supplied spanner:

Clockwise = closed

Anti-clockwise = open (see figure)



Spanner (included)

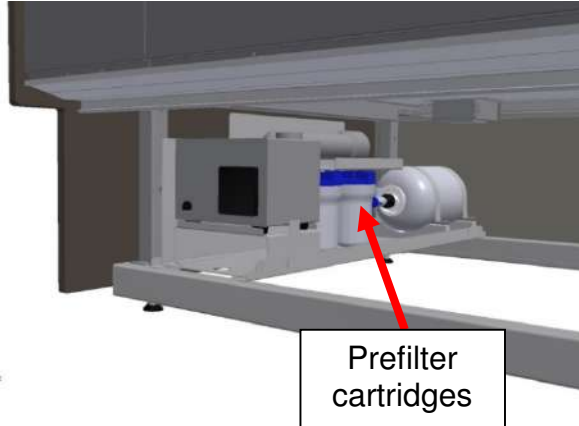

For more information about your micro-misting please refer to the manual (supplied by Smeva).

**Optional reverse osmosis filters for units equipped with a humidifier**

For the benefit of the public health, for protection of the humidifier and to maintain the freshness of the products, every display case with humidifiers must use purified water.

A water purification system that is working poorly or has been bypassed can lead to contamination with legionella bacteria, which poses a danger to both the personnel and the public.



Contamination of the water can cause the humidification system to function poorly or become defective.

To replace the reverse osmosis (RO) prefilter cartridge, follow the instructions supplied with the filter cartridge.



The recommended interval for replacement of the RO prefilters is six months.



You must have the reverse osmosis system inspected at least once a year by a maintenance technician with the necessary training.

4 Cleaning & maintenance

- **General**

For display cases with non-removable cold plate, regularly rinse the presentation surface with warm water and carefully rinse the drains clean. Use a damp cloth for display cases with a removable presentation surface. Never spray water on the electrical parts beyond this surface.



The ice that builds up in the drain must be rinsed out with warm water at least once every seven days. If cleaning is not performed regularly, the ice from the evaporator will build up in the drain and block the airflow.



As owner and/or HACPP manager you are legally required to document the maintenance of the display case.



For the purposes of product liability and warranty you are required to have your display case inspected annually by an authorized technician.

This inspection must include the following:

1. Cleaning of condensation drains, air ducts and the water drain system. Timely repair of degraded or damaged materials or coatings, and seals, to prevent possible corrosion and water leaks.
2. Cleaning and inspection of moving parts, cables and temperature sensors and the controller. All damaged materials must be professionally repaired or replaced with OEM parts to prevent the risk of electrical shocks and failure or malfunction of the display case.
3. Adjustment of the thermostatic adjustment valves and inspection for possible leakage of refrigerant from the display case. In the case of leakage, you are legally required to have the leak repaired before you charge or top off the system with new refrigerant.

The legally mandated interval for leak inspection depends on the type of refrigerant and the total capacity of the refrigeration system. This information is available from your Smeva partner or refrigeration installer on request.

4 Cleaning & maintenance	Vision MKII	
--------------------------	--------------------	--



When cleaning the display case glass, do not open all the glass panels at the same time. This causes unnecessary, excessive stress on the structural parts, leading to deformation of the structural system and possible breakage of the glass.



Due to the low visibility of the glass, do not leave the display appliance unattended with the glass panel in the open position; employees and customers might walk into it.

Cleaning:



Before cleaning the presentation surface always switch off the refrigeration system at the control panel.



Clean the presentation surface with soap and plenty of water. Never spray water on the electrical parts outside this area:

- The control panels
- The mains sockets
- The fan
- The anti-condensation nose fans (hidden behind the nose profile)
- The lighting
- The technical areas located inside the frame.

**Cleaning**

Clean with a cloth and warm soapy water. Then dry the display case.

Never use harsh cleaners. Only use cleansers with a pH (acidity) of between 4 and 9. Always follow the manufacturer's instructions for dilution etc. shown on the packaging.



When working in the display case one must always be aware of the potential risk of electrical shocks. When there is no master switch or electrical plug that supplies the device, the power must be switched off at the circuit breaker on the shop's main circuit panel.

Exterior of the appliance (laminated sheet)

A prelaminated decorative sheet can be cleaned in the usual manner with a cloth and warm soapy water. Aggressive cleaners may scratch the surface of the laminated sheet.

Exterior of the appliance (anti-fingerprint (AFP) stainless steel)

AFP stainless steel can be cleaned with a mild cleanser and warm water. Rinse with clean water and dry with a soft cloth to prevent spots. See below for more information about more difficult-to-remove contamination or spots on AFP stainless steel.



Cleaning AFP stainless steel (severely contaminated surface or difficult-to-remove spots)
For difficult-to-remove contamination use a non-abrasive multipurpose cream cleanser applied with a soft, damp cloth. Rinse with clean water and dry with a soft cloth.

Interior of the appliance (stainless steel)

Surface corrosion on stainless steel can be removed with a soft, damp cloth and a multipurpose cleanser.

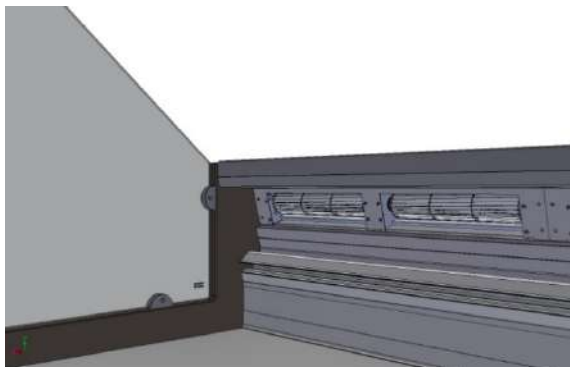
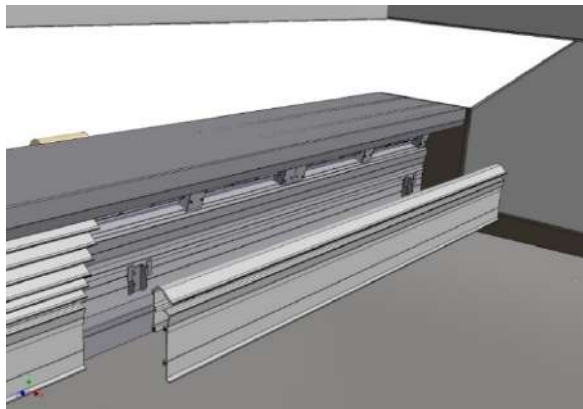
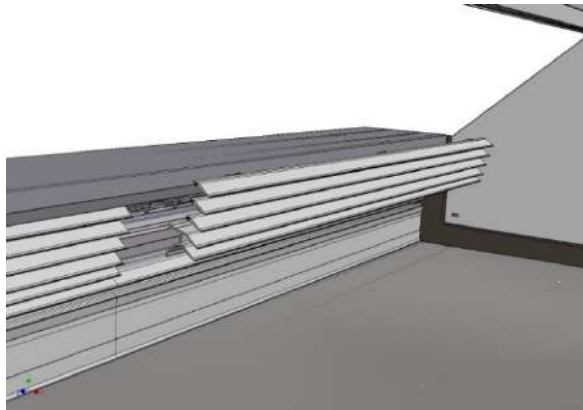

Presentation surface and the grilles

The stainless steel presentation surface and the aluminium grilles come in contact with food products.



The discharge and intake grilles can be removed for easier cleaning of the presentation surface.



Clean this wet stainless steel surface with warm water (± 50 °C) and soap, and rinse with lots of clean water.



Free of contamination



We recommend that the presentation surface and discharge and intake grilles be cleaned every day.

Fan (for fresh products with non-removable cold plate)



Do not use sprayed water.
Contact your Smeva dealer when the air circuit above the evaporator becomes dirty inside.

Fan (for packaged products with a removable presentation surface)



Do not use sprayed water.

4 Cleaning & maintenance	Vision MKII	
--------------------------	-------------	--



Drains



Clean the drain channel with a cloth and warm soapy water. Rinse the drains with lots of clean water.



Work surface

The stainless steel work surface is subject to contamination with salt/blood.



Clean this dry stainless steel surface regularly with lots of warm water.



Dry this surface carefully after cleaning.



Dry



Do not use abrasives or aggressive cleansers.

Display case glass panels general



Completely open



Clean the glass with water, and use methylated spirit if necessary.



Free of grease and fingerprints



Replacement of gas spring Vision KU flat glass top-hinged

To replace the gas spring, the glass must first be removed from the two clamps.

Use a Torx screwdriver to loosen the clamping block.



Torx screwdriver



The following photos show how to remove a gas spring from the support.

Use a slotted screwdriver to release the metal spring clips.

Use a slotted screwdriver to pry the gas spring off of the ball joint.

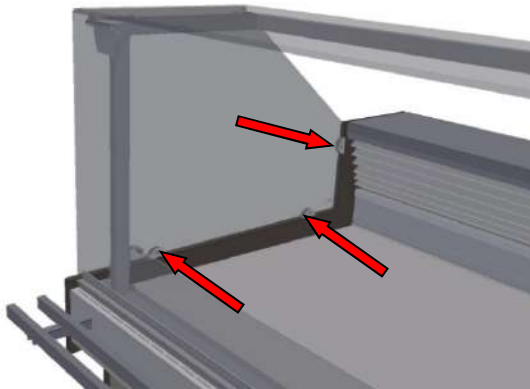

Screwdriver

**Serve-over display case Vision**

The glass end panels in the display case are attached to the side with three special holders with adjustment screws (see arrows in the figure).



The top edge of the side window is attached to the light profile with a screw.

The adjustment screws can be turned with a large screwdriver or a coin, making it possible to adjust the glass end panels (approximately 5-8 mm).



Large screwdriver or coin



Keep in mind that when a support is adjusted (using the adjustment screw), it may also be necessary to adjust the glass end panel.



Fitting & adjusting glass panels Vision KU flat glass

1. Adjust the glass panels until they are in the correct position by manually turning the adjustable supports in/out.



First release the gas spring by fully opening the glass panel.



Aligned

2. Align the left/right position of the glass panels carefully by releasing the stops in the hinge profiles.

This is done by loosening the socket-head screws several turns.



Allen wrench 3 mm



Correct left/right position



Gap between glass panels 2-6 mm

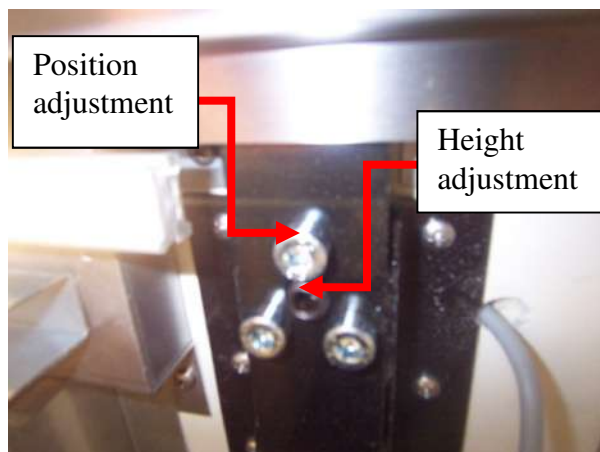

Height adjustment

Adjust the height of the glass panels by loosening the three metal-coloured bolts several turns. The height is adjusted by turning the black bolt in the middle in/out. Tighten the three bolts once the height is adjusted correctly.



Correct height

Position the bracket by loosening/tightening the outer bolts.



Correct position



Fitting & adjusting glass panels (Vision PA Panorama) bonded glass

1. Open the glass panel and remove the round plastic profile.
2. Set the adjustment screw to the correct position.



Profile in/out to desired position



Small slotted screwdriver

3. Place the round plastic profile back into the aluminium profile.



Correct position



Do not move the glass panel back to the closed position without the plastic profile; otherwise the glass panel may be damaged.

5 End of life, disassembly & disposal	Vision MKII	
---	--------------------	--

5 End of life, disassembly & disposal

Your Vision display case is designed for an intended service life of 15 years. However, the actual service life depends on the conditions in which it is used and the intensity of use.

The Vision display case contains specific parts that are subject to wear. These parts must be replaced during the service life of the display case.

In terms of recycling or the reuse of parts at the end of the service life, specific parts can be used again in a second life cycle. Contact your Smeva dealer for the responsible, sustainable disposal of the display appliance.



When discarded, the display case must be disposed of in accordance with local regulations.



Refrigerants (CFCs) are subject to the Kyoto Protocol.



For the materials used in the display case, see Chapter 7.

Refrigerant	Global Warming Potential/CO ₂ Eq
R134a	1430
R404A	3922
R507	3985
R407A	2107
R407C	1774
R407D	1627
R407F	1825
Natural refrigerant	
R744	1
R290	3

6 Troubleshooting



This list has been compiled based on the assumption that the equipment was functioning normally prior to the malfunction.

General malfunction



If the display case no longer functions, check whether the mains power supply is present:

1. Check the fuses or circuit breakers for the circuit to which the Vision display case is connected.
2. Check the residual-current device for the circuit to which the Vision display case is connected.



Fuse OK or circuit breaker on



Residual-current device on



If you cannot find the cause, contact your Smeva partner.

Partial malfunction



If the Vision is only partially malfunctioning and you are not able to resolve the problem by switching the affected function off and on again, contact your Smeva partner.



Never open the control panel or switch box

Malfunction of the (optional) humidifiers



If the humidifier produces too little or no mist, first check the water supply and the reverse osmosis filter. If this does not help, consult the manual for the device or contact your Smeva partner.

7 Product identification	Vision MKII	
--------------------------	--------------------	--

7 Product identification	
Physical data Front glass panel: Side glass panel: Presentation surface Work surface Side walls and panels Insulation: Profiles: Frame:	Tempered glass Tempered glass AISI 304 stainless steel AISI 304 stainless steel (other materials available) PVC hard foam, painted and galvanized steel Polyurethane foam* Anodized aluminium Power coated steel and galvanized profiles with adjustable feet  *Polyurethane parts fabricated without the use of greenhouse and ozone-depleting gases.
Electrical data Controller: Power supply: Rated power:	Based on customer specifications 230 VAC, 50 Hz, max. 16 A As shown on machine sticker
Refrigeration data System volume: Pressure: Refrigerant:	As shown on machine sticker As shown on machine sticker As shown on machine sticker Chemical composition intended for specific type of refrigerant

7 Product identification	Vision MKII	
--------------------------	-------------	--



For quick assistance when you have questions or in the event of a malfunction, the left compartment on the serving side of your Vision display case contains the machine stickers shown below. Copy this information and provide it to your maintenance technician in the event of problems or defects.



Smeva B.V.
J.F. Kennedylaan 27
6655 XC Valkenswaard
The Netherlands

Identification number	1234567890
Production date	January 2013
Type	Vision RO A
Length	2 m
Refrigerant	R404a
Circuit volume	4.9 dm ³
Design pressure	HP 27.6 Bar(a) LP 18.0 Bar(a)
Design temperature	60.0 °C

Contains, according to the Kyoto Protocol, fluorinated greenhouse gases

Remote condensing unit	Art. 33
Hermetically sealed	
Class 97/23/EG	Module A
Cert.-nummer	



Smeva B.V.
J.F. Kennedylaan 27
6655 XC Valkenswaard
The Netherlands

Identification number	1234567890
Production date	January 2013
Type	Vision RO A
Length	2 m
Voltage	~240 V
Frequency	60 Hz
Electric load cabinet	0.03 kW
Electric load defrosting	0.00 kW
Circuit breaker max.	16 A

Class 99/37/EEG

Cert.-nummer 

Notes: